

- S1: SWITCH, REC/P.B. : (AT RECORD POSITION)
 S2: SWITCH, CHANNEL SELECTOR (CHANNEL-1 POSITION)
 S3: SWITCH, AUTO/MANUAL SELECTOR (MANUAL POSITION)
 S4: SWITCH, EQUALIZER (ON 3¼ & 1½ 1PS POSITION)
 S5: SWITCH, EQUALIZER (ON 1½ 1PS POSITION)
 S6: SWITCH, SPEAKER ON/OFF
 S7: SWITCH, POWER ON/OFF
 S8: SWITCH, AUTOMATIC SHUT-OFF

VALUES IN PARENTHESES ARE MEASURED WITH 0 SIGNAL ON DC

Exploded Diagrams

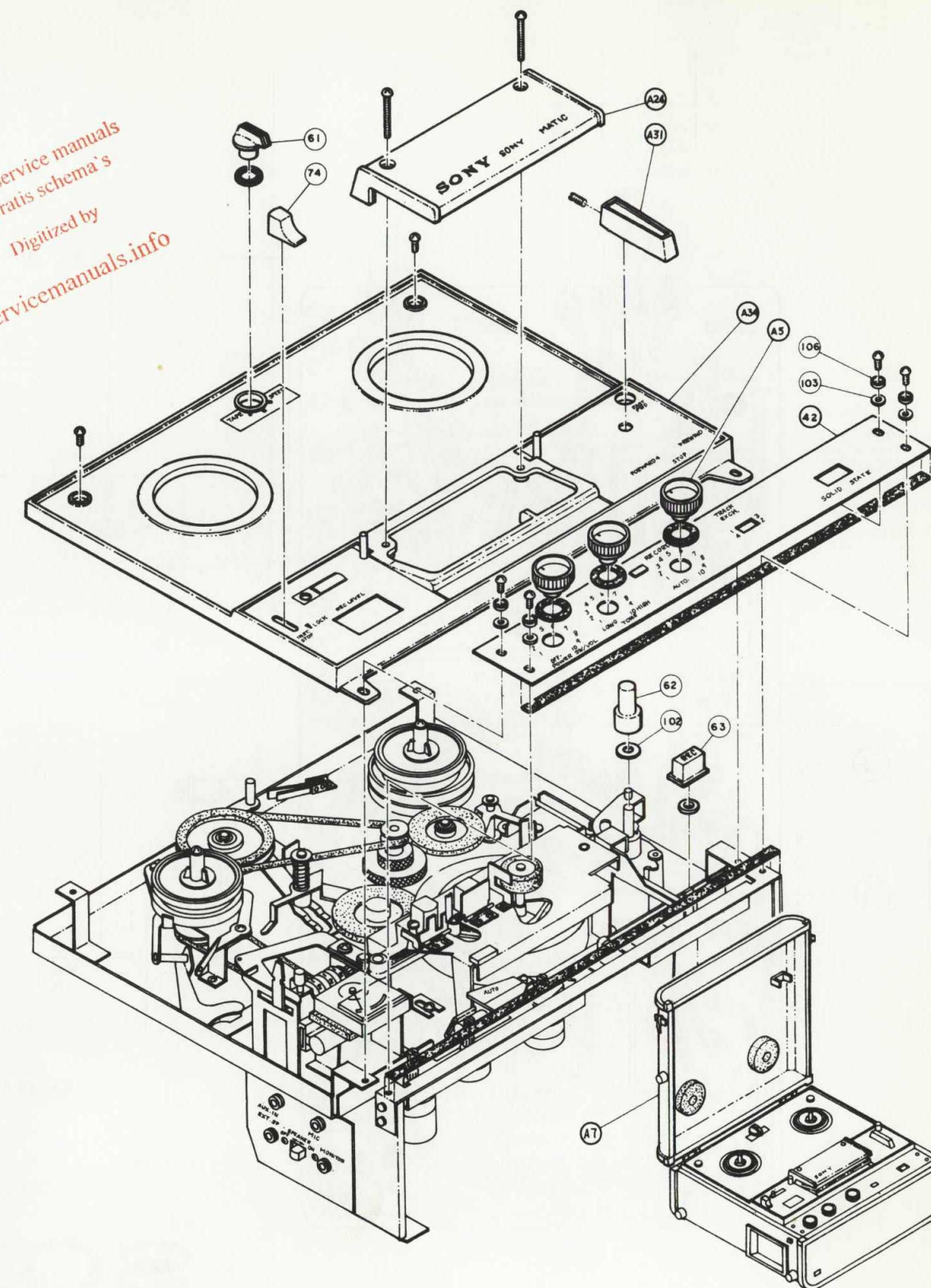
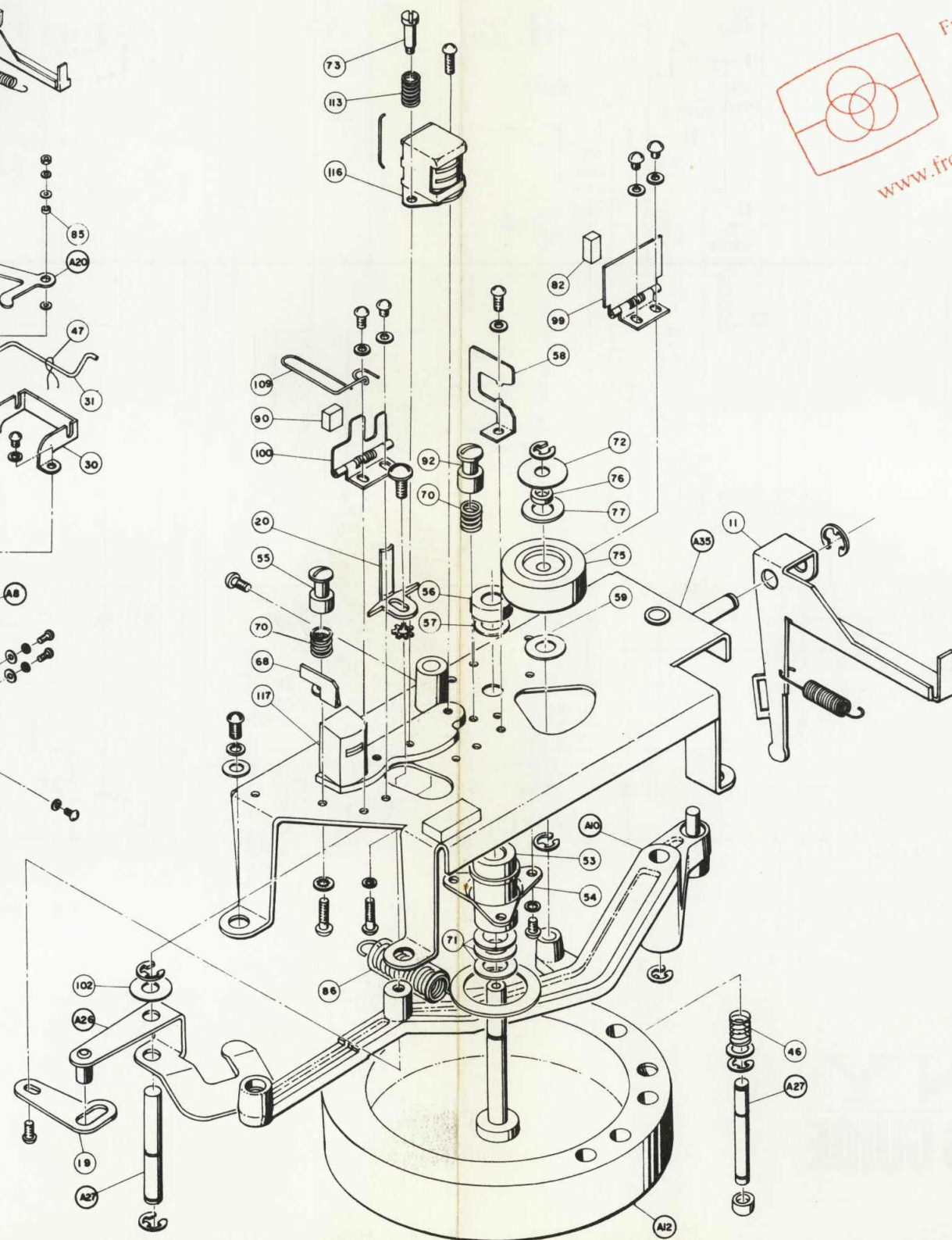
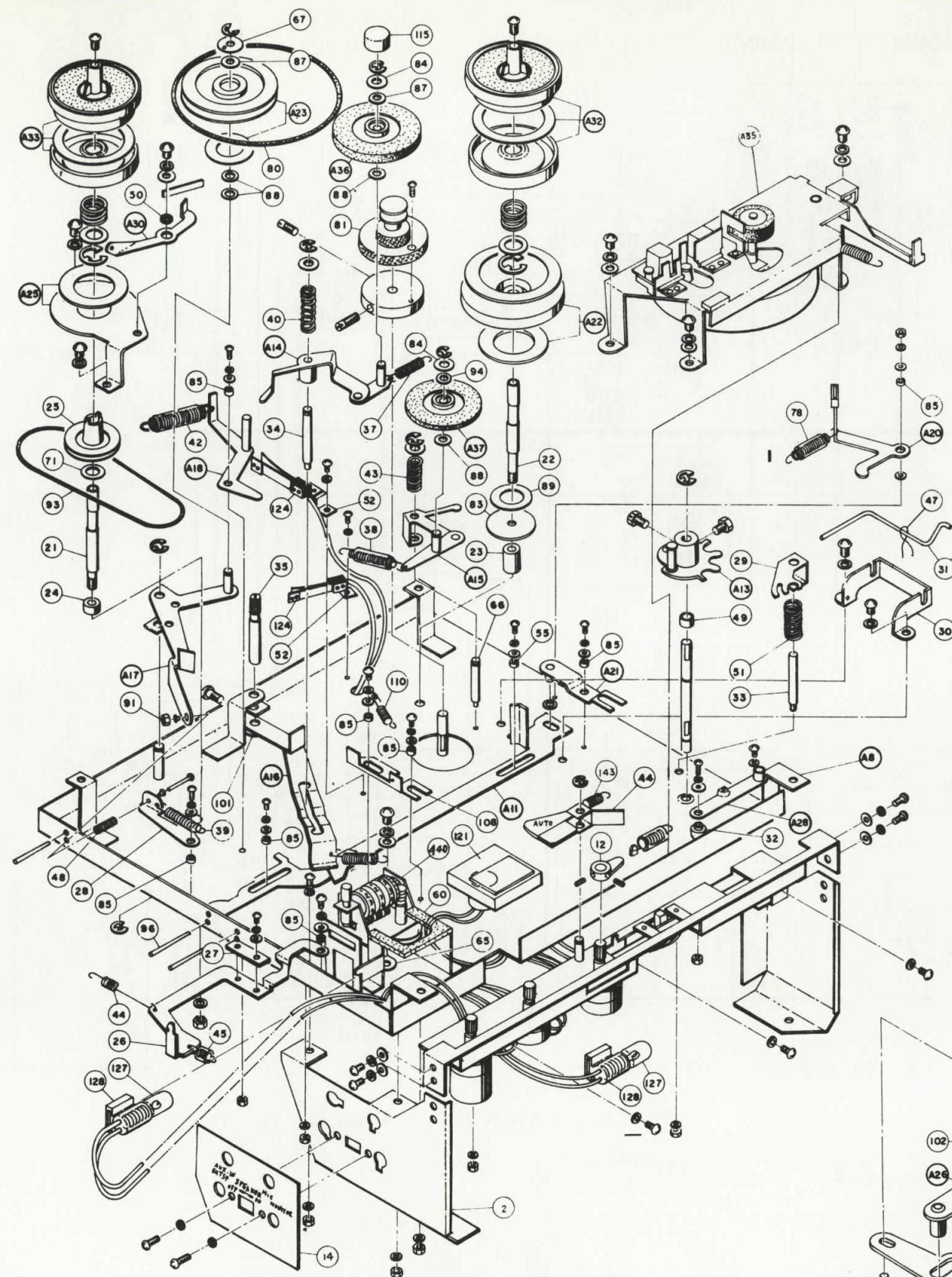

Free service manuals
Gratis schema's
Digitized by
www.freeservicemanuals.info